

80 Strand — London

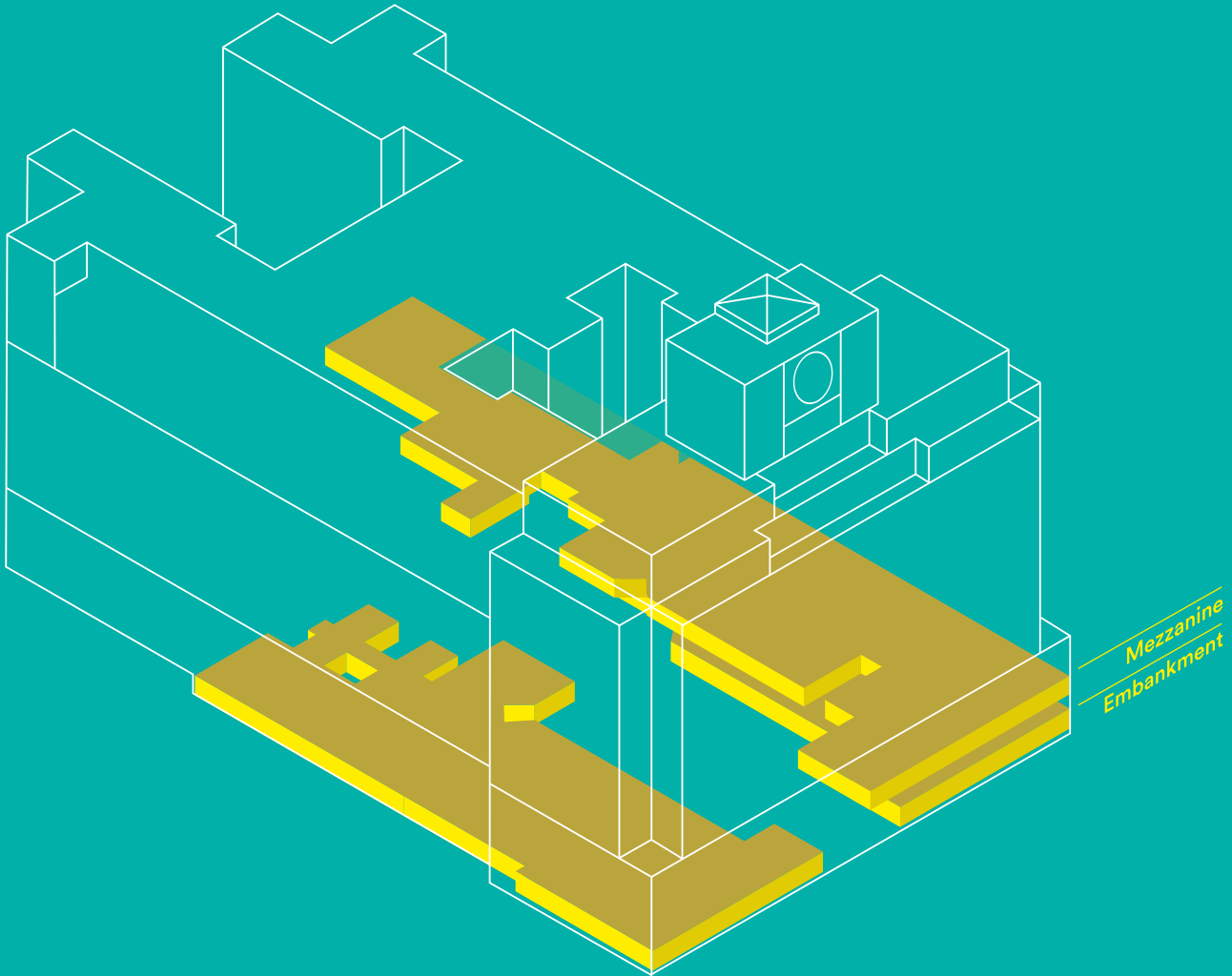

Up to 36,500 sq ft of exceptional offices are available across Embankment and Mezzanine levels. The western split on Mezzanine level has been let, leaving 15,980 sq ft on the eastern side. The Embankment level can be sub divided, providing offices from 8,793 sq ft. This level connects directly to all communal amenities including Glasshouse Gardens.

LEVEL		SQ FT	SQ M	STATUS
Mezzanine	Total	15,930	1,480	Available
Embankment	Total	20,651	1,919	Available
	Tenancy A	11,858	1,102	
	Tenancy B	8,793	817	
TOTAL		36,581	3,399	



Mezzanine
Tenancy A: Occupied
Tenancy B: 15,930 sq ft / 1,480 sq m

03—04

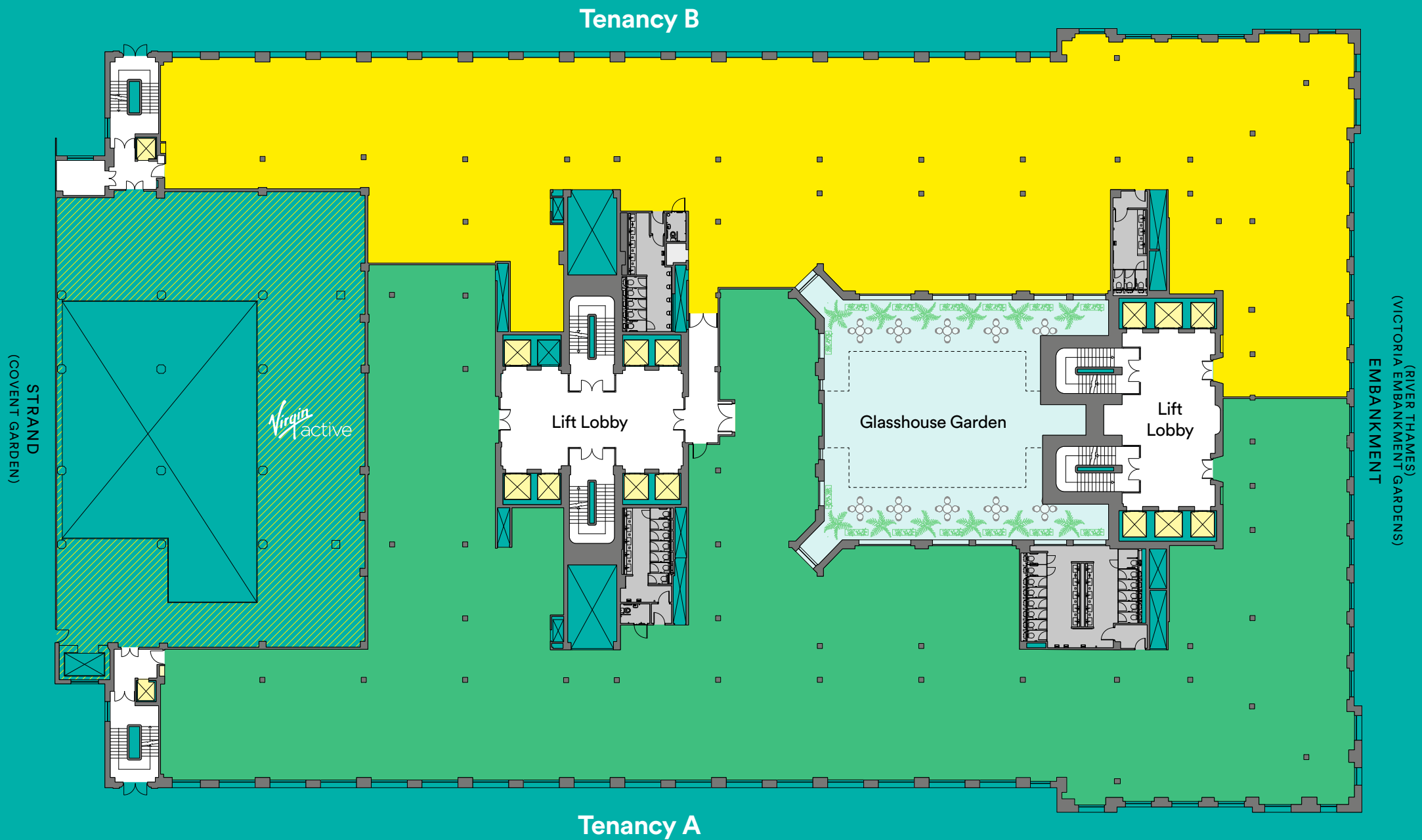

- Office
- Lifts
- WCs
- Voids

Not to scale. For indicative purposes only.





The combined benefit of external windows and internal views in to Glasshouse Garden ensures the uninterrupted runs of the Mezzanine floorplate are flooded with high levels of natural light.



Indicative corporate-style fit-out. Mezzanine level.

Occupancy ratio

1:8

1:12



Indicative media-style fit-out. Mezzanine level.

Occupancy ratio

1:8	1:12
-----	------

Embankment
Total: 20,651 sq ft / 1,919 sq m

11—12

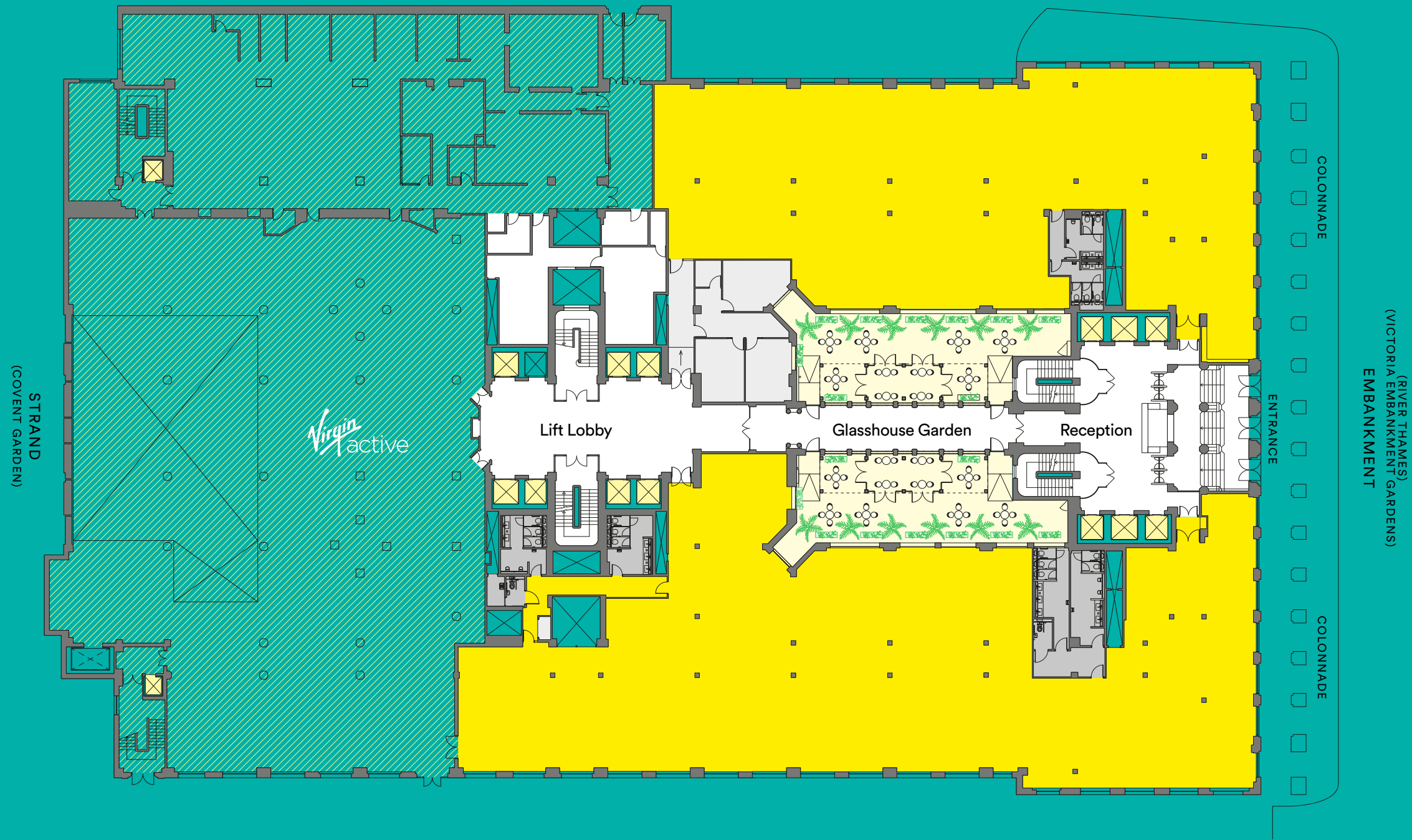

- Office
- Lifts
- WCs
- Voids

Not to scale. For indicative purposes only.



Tenancy A

11,858 sq ft / 1,102 sq m
Total headcount

- Open plan
- Reception
- Executive Offices
- Meeting Rooms
- VC Rooms
- Common areas

Tenancy B

8,793 sq ft / 817 sq m
Total headcount

- Open plan
- Reception
- Executive Offices
- Meeting Rooms
- VC Rooms
- Common areas

- Office
- Lifts
- WCs
- Voids

Not to scale. For indicative purposes only.

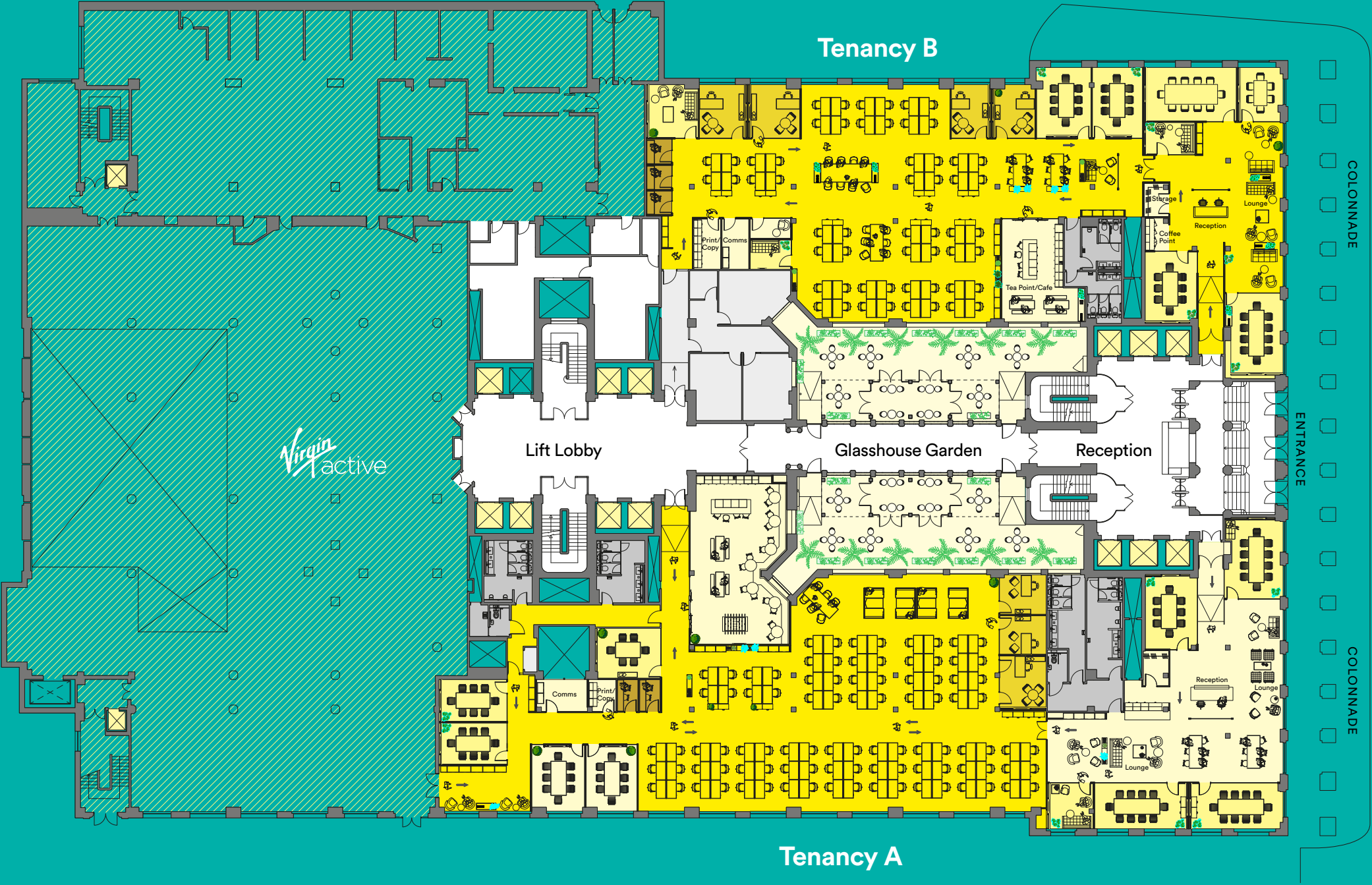

A view from the Glasshouse Garden looking into the Embankment level offices which benefit from immediate on-floor access to this unique space.





The Embankment floorplate benefits from external views in to Embankment Gardens and internal views in to the Glasshouse Garden. The Embankment floorplate is flooded with natural light.



Characterful arch windows,
with views towards the river,
provide excellent natural light.

Professional Team

Project Management
Mace

Cost Consultant
Gardiner & Theobald

Architect & Principal Designer
TP Bennett

Mechanical & Engineer,
Lighting Design and Security
Hurley Palmer Flatt

AV Consultant
Mix Consultancy

Structural
Berkley Design Professional

Acoustic
Sandy Brown

For more information, please contact:

CBRE

Matt Chicken
matt.chicken@cbre.com
07852 205 099
020 7182 2023

Alex Kerr
alex.kerr@cbre.com
07867 185 924
020 7182 2511

Nathalie Spink
nathalie.spink@cbre.com
07385 414 222
020 7182 2000

Tom Meijer
tom.meijer@cbre.com
07540 595 379
020 7182 2778

GRYPHON

Colin Hargreaves
colin@gryphon.uk.com
07778 164 159
020 3440 9804

Rob Riley
rob@gryphon.uk.com
07764 166 230
020 3440 9800

Andrew McCallum
andrew@gryphon.uk.com
07552 604 743
020 3440 9800

Misrepresentation Act 1967 and declaration. CBRE and Gryphon Property Partners for themselves and for the lessor as agents for the lessor gives notice that: 1. We provide the information contained in these particulars for guidance to intending lessee, licensees or any other third parties and they are for your general information only and will be used at your own risk. 2. We will use all reasonable endeavours to ensure the accuracy of information, however, we do not guarantee or warrant the accuracy or completeness, factual correctness or reliability of any information in the particulars (especially as the information may have been obtained from third parties) and do not accept any liability for any errors or omission including any inaccuracies or typographical errors. 3. Any interested lessee, licensees or any other third parties should not view the information in the particulars as statements or representations of fact and should satisfy themselves that the facts and specific details in the particulars are correct and accurate especially in relation to floor areas and other measurements through inspection or other means, as appropriate, and will be responsible for taking independent surveys or valuations before entering into any legally binding transaction in respect of the property or premises that is the subject matter of these particulars. 4. We have not made any investigations or otherwise of any issues concerning pollution and potential land, building, air or water contamination. Prospective lessee, licensees or any other third parties undertake their own enquiries and satisfy themselves in this regard. 5. Unless otherwise stated, all prices and rents are quoted exclusive of VAT. Computer generated images are for indicative purposes only. January 2024.

80strand.london